

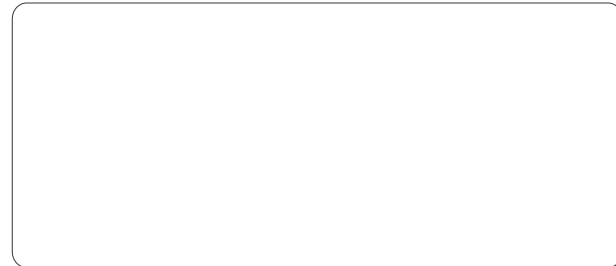

Authorised Distributor / Dealer



Design and Specifications are subject to change without prior notice

Geeken Design Concepts Pvt. Ltd.

**Plant & Office:**

Vill. Bhatoli Kalan, Near EPIP Jharmajri,  
Baddi-173 205 H.P. (India)  
T:01795-271334 | 01795-271335  
E: geekendesign@gmail.com  
E: ravigeeken@gmail.com  
W: www.geekendesign.com

**Punjab Office:**

3rd Floor, Gopi Krishna Tower,  
Near Kamal Palace Hotel,  
Civil Lines, BMC Chowk,  
Jalandhar City  
T: +91-181-46001453  
M: +91-98152-01706

**Mohali Office:**

Sec 82, Plot No. 984  
Mohali.  
M: +91-92185-10180



a premium product of geeken design concepts pvt. ltd.



*Add style to your workplace*



Modular Furniture Series

## Working Network Map



Ahmedabad | Asansol | Aizawl | Bangalore | Bikaner | Bareilly | Bathinda | Bhuj | Berhampore | Chandigarh | Chennai | Coimbatore | Delhi | Dimapur | Durgapur | Guwahati | Gaya | Hyderabad | Haldwani | Hubli | Imphal | Itanagar | Jaipur | Jammu | Jabalpur | Kolkata | Kohlapur | Kochi | Kanpur | Kurnool | Karim Nagar | Kharagpur | Kohima | Ludhiana | Mumbai | Madhurai | Mirzapur | Nasik | Ongole | Pune | Patna | Pathamnamthitta | Raipur | Rourkela | Ranchi | Solan | Sriganganagar | Surat | Siliguri | Shillong | Salem | Sambalpur | Trivendrum | Trivively | Trichy | Udaipur | Vijaywada | Vishakhapatnam | Varanasi | Warangal



## MESSAGE FROM THE DESK OF MANAGING DIRECTOR



We introduce ourselves as manufacturer of premium quality office furniture in the brand name of EVA. We manufacture chairs, sofas and other modular furniture for the office.

Our chairs and sofas give the best of comfort. Our chairs are designed to give ultimate comfort and soothing effect to each and every nerve and curve of your backbone.

The posture of chairs and that of the body should match absolutely giving absolute comfort and we have achieved the same in our designs. We have designed our chairs for healthy posture and a proper shape of the spine enabling you for the long working hours for sitting job.

Our chairs are best at physical ergonomics, good looks, best quality and durability. Sitting on an EVA brand chair is a wonderful experience which keeps you cheerful, happy, fresh and comfortable.

We have the latest machinery, best advanced technology and we use the best material. We source our raw material from the best companies in India and abroad like Tata Steel and Hettich etc.

Modular offices are in style, need and the trend of the day. Modular offices have minimized the role of the carpenter. Gone are the days when it used to take months to furnish the office. Now we are ready with the solution as per your requirement, saving your precious time and efforts. We make office tables, reception counters, conference tables and modular workstations.

We offer variety of color choice. We design the office and furniture as per your choice and requirement of your work place. We focus on quality, comfort, good looks and durability.

**Ravi Shukla**  
Managing Director

# INNOVATE



75mm partition based on "clip-on" type tile system, industry's best selling and pioneer product, we design this system keeping with same specification & different look with add on features.

**INNOVATE 1**  
W 3150 x D 1575 x H 1200

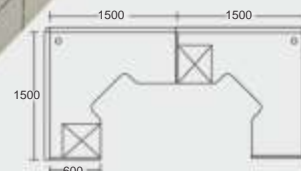

# CURVE



Only partition system with aluminum section top cover profile. Wherein flexibility to give both curve and straight shape to the partition.

**CURVE 1**  
W 3050 x D 1525 x H 1200

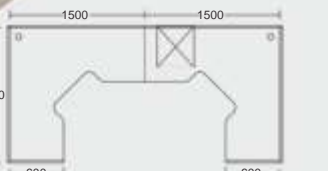

**INNOVATE 2**  
W 1575 x D 1575 x H 1200



**INNOVATE 3**  
W 3075 x D 1575 x H 1200

## Combining the art of Design & Functionality



### Product Technical Specification

- 75mm thick tile based partition system.
- Aluminum extruded sections.
- Hook and Clip tile system.
- 100mm high raceway for data & electrical wiring.

### Product Features

- Clip on type tile for easy re-installation.
- Powder coated aluminum frame rust and corrosion proof.
- Strong & Stable partition.
- Options in tile – Fabric, Soft Fabric, Glass, Frosted Glass, magnetic board & white board.
- Innovative design to carry cables with horizontally and vertically.
- 75mm frame provides optimum space for heavy cables
- Option of 2 snap fit aluminium raceways for data and power cables to avoid data corruption.
- Level adjusters for uneven surfaces.
- Expandable in height, length & width.
- Configuration Possible in Straight & 90 degree.



**CURVE 2**  
W 1525 x D 1525 x H 1200

### Product Technical Specification

- 25mm thick pole based partition system.
- Aluminum extruded sections.
- Panel based solid partition
- Raceway for data & electrical wiring.

### Product Features

- Slim look.
- Can be use with Innovate as a side spine/divider/privacy panel.
- Curve shape of partition is possible.
- Powder coated aluminum sections rust and corrosion proof.
- Great flexibility and can be installed in very short notice
- Options of – Fabric, Soft Fabric, white board and laminate.
- Wiring is possible through an internal/external raceway.
- Snap fit aluminum raceway for data and power cables
- Level adjusters for uneven surfaces.
- Configuration Possible in Straight, 90 degree and 120 degree.

# INNOCURVE

This is a handshake combination of Innovate & Curve, wherein one can easily decrease the cost of project without changing layout and configuration.

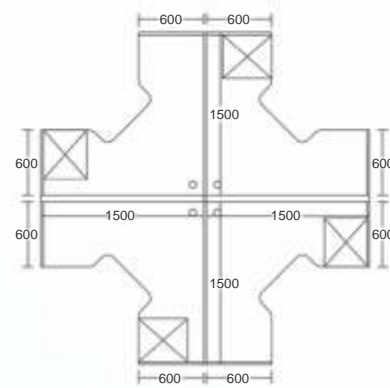

**INNOCURVE 1**  
W 3025 x D 3075 x H 1200

## Freedom to Work

### Product Technical Specification

- Main Spine - 75mm thick tile based partition system.
- Side Spine - 25mm thick pole based partition system.
- All Specification Same as Innovate and Curve.
- 75x25mm aluminum post connects both partitions.

### Product Features

- It is a Handshake combination of Innovate and Curve partition.
- Curve shape of the partition gives a unique looks and open feel of the office.
- This combination reduces the cost of project.
- Main spine (Innovate) use for wiring of data and power cables.
- Side spine (Curve) use for privacy panel.
- Strong & Stable combination of both partition systems.
- Configuration Possible in Straight & 90 degree only.



**INNOCURVE 2**  
W 1575 x D 1525 x H 1200

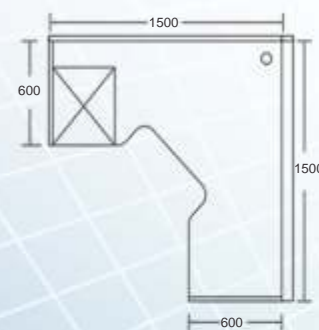

# AXIS

Axis is ideal for people who prefer something light on the eyes, light on the space and light on the pocket.

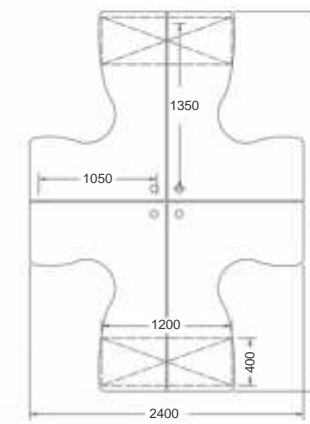

**AXIS 1**  
W 3000 x D 2400 x H 1200



**AXIS 2**  
W 4950 x D 2400 x H 1200

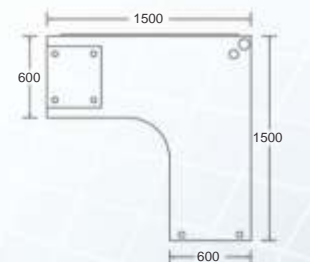
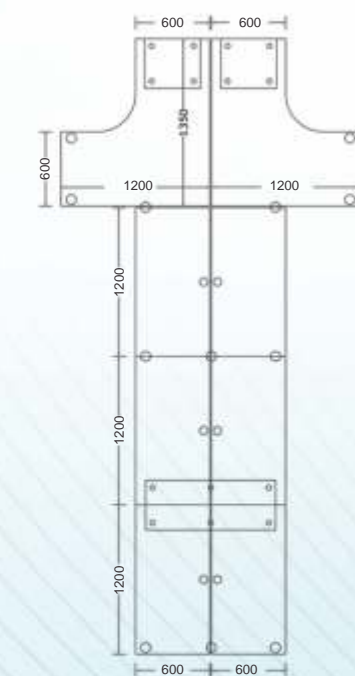

### Product Technical Specification

- Desk based System with Screen.
- Screen made of 12mm thick MDF deco painted.
- Work top support by metal powder coated legs.
- 100mm high hanging raceway below the work top for data & electrical wiring.

### Product Features

- Axis creates the most perfect office environment with great simplicity and clarity.
- Most usable product & design for low budget projects.
- 12mm thick screen gives slim look to the workstation.
- Axis gives openness feel to the user with privacy.
- Great flexibility and can be installed in very short notice.
- Hanging Snap fit aluminum raceway below the worktop for data and power cables.
- Configuration Possible in Straight and L – Shape.

# OPTIMUM

Modern style and refreshing colors optimum design totally based on European open desk system. Working atmosphere become more harmonious since desking System encourages people to communicate; connecting people as a result enhances productivity of your work forces.



**OPTIMUM 1**  
W 3000 x D 3000 x H 1200

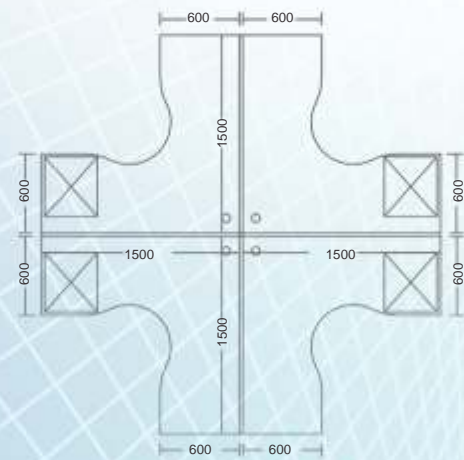

# OPTIMUM

## Product Technical Specification

- Desk based System with partition / Screen.
- 25mm thick partition for privacy, pin-up & marker.
- Powder coated triangle frame leg.
- Raceway provision below the work top for data & electrical wiring.

## Product Features

- One system many roles, it can be use to create multiple workstation options.
- Optimum serves equally good as a workstation, as conference table and as an executive desk.
- Strong, stable and slim look, it takes – up less space.
- Simple, sleek and open design gives aesthetic look to the office.
- Optimum gives more & open space to work with privacy.
- Great flexibility and can be installed in very short notice.
- Configuration Possible in Straight and L – Shape.
- Powder coated legs rust and corrosion proof.
- Wiring through raceway below the worktop.

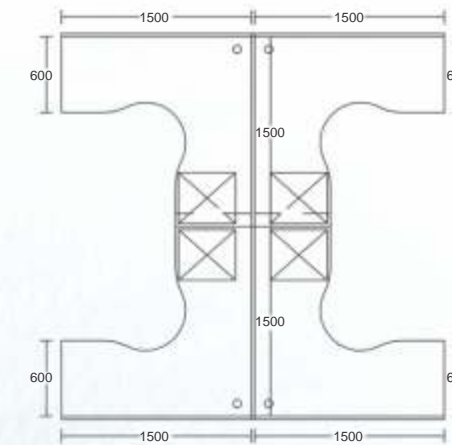

**OPTIMUM 2**  
W 3000 x D 3000 x H 1200



**OPTIMUM 3**  
W 1650 x D 1650 x H 750

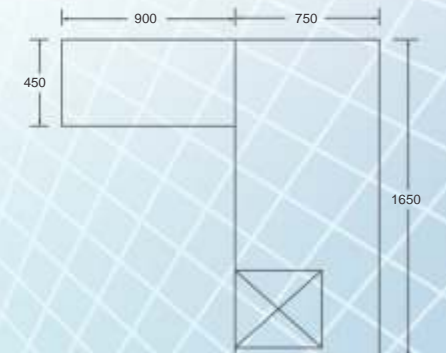

# STRATUM

## Efficient Working

Panel based partition system with flat trims and different color insert strip at end of partition to give colorful & unique look to the office.



**STRATUM 1**  
W 3180 x D 3180 x H 1650

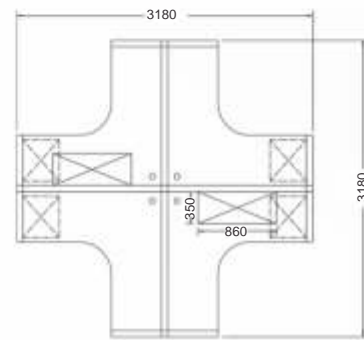

# STRATUM



**STRATUM 5**  
W 2520 x D 1260 x H 1200

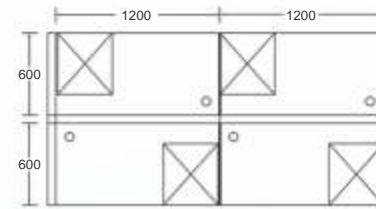

**STRATUM 2**  
W 2460 x D 1200 x H 1200

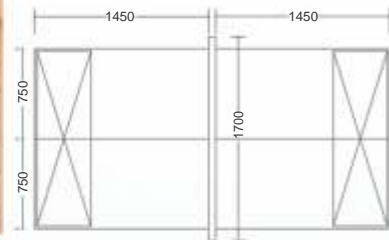

**STRATUM 3**  
W 3660 x D 3660 x H 1200

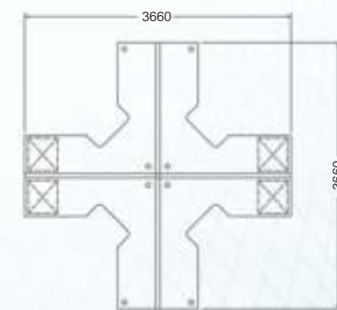

**STRATUM 4**  
W 2860 x D 4500 x H 1200

### Product Technical Specification

- 60mm panel based partition systems.
- Flat top and end covers.
- End covers with sliding strips.
- Aluminum extruded sections.
- 100mm height of raceway for data & electrical wiring.

### Product Features

- Panel based system for easy re-installation.
- Flexible & expandable without disrupting harmony of design.
- Simple to re-configure
- Powder coated aluminum frame rust and corrosion proof.
- Options of –Fabric, Soft Fabric, Glass, Frosted Glass, magnetic board & white board.
- In-built wire raceways for concealed wiring
- Optional additional raceway for LAN wiring
- Level adjusters for uneven surfaces.
- Expandable in height, length & width.
- Configuration Possible in Straight and 90 degree.



**STRATUM 6**  
W 3120 x D 1560 x H 1800

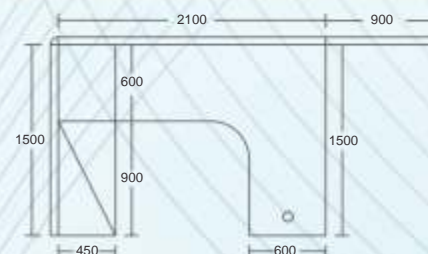

**STRATUM 7**  
W 1860 x D 1860 x H 1200

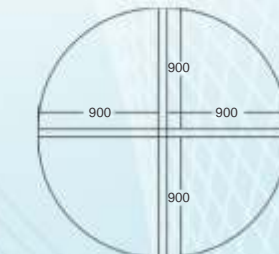

MAX



MAX 1  
W 3720 x D 1560 x H 1200

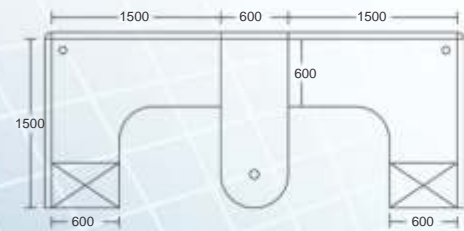

MAX 2  
W 3060 x D 3060 x H 1200

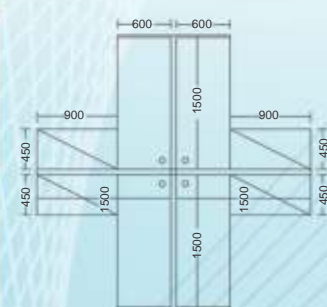

MAX 3  
W 3060 x D 1500 x H 1200

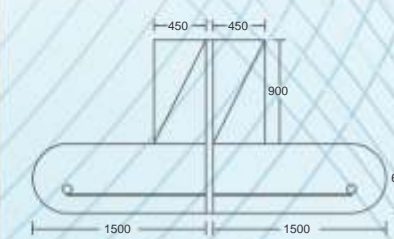

MAX

MAX 45  
MAX 60

Geeken's pioneer and maximum selling product throughout the years, thousands of customers are satisfied using this product.

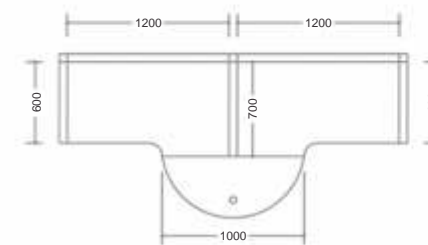

MAX 4  
W 2580 x D 1260 x H 1200



MAX 5  
W 1320 x D 660 x H 1200

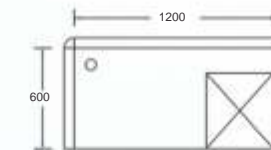

MAX 6  
W 2520 x D 1260 x H 1200

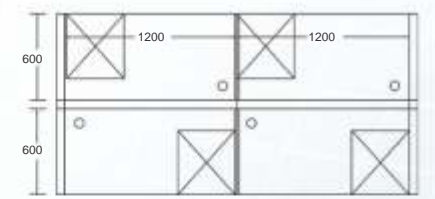

Product Technical Specification

- Max available in two thicknesses of 45mm and 60mm.
- Panel based partition system.
- Aluminum extruded sections.
- 100mm height of raceway for data & electrical wiring.

Product Features

- Proven performance and competitive price still maintains its market position.
- Panel based systems make this partition to easy to install and easy to dismantle.
- Re-installation as easy to first installation.
- Powder coated aluminum frame rust and corrosion proof.
- Options of -Fabric, Soft Fabric, Glass, Frosted Glass, magnetic board & white board.
- Option of 2 snap fit aluminums raceways for data and power cables to avoid data corruption.
- Level adjusters for uneven surfaces.
- Expandable in height, length & width.
- Configuration Possible in Straight, 90 degree and 120 degree.
- In-built slot to hold range of accessories.



**DYNAMIC**  
SERIES



**Product Features**

- Eye catching and attractive finish.
- Turn your office into a modern, functional and organized space with the dynamic tables.
- One side runner, Pedestal unit, keyboard-tray, CPU trolley and wire management grommet hole.

**DYNAMIC 1**  
W 2100 x D 800 x H 750

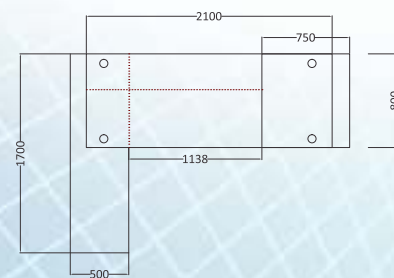

**DYNAMIC**  
SERIES



**DYNAMIC 2**  
W 2400 x D 900 X H 750

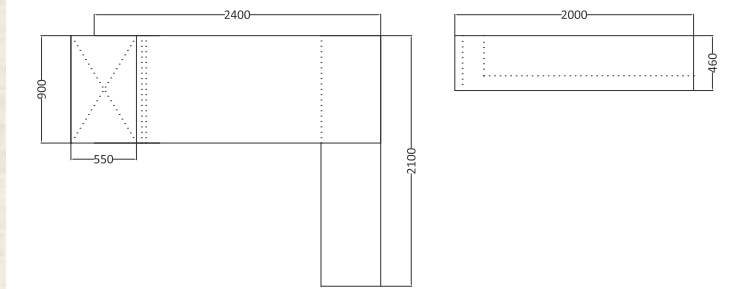

**Product Features**

- Modern appearance & innovative designs.
- Make the most out of your work space with ample storage space with the drawer pedestal unit and side runner.
- It includes keyboard tray and CPU trolley.

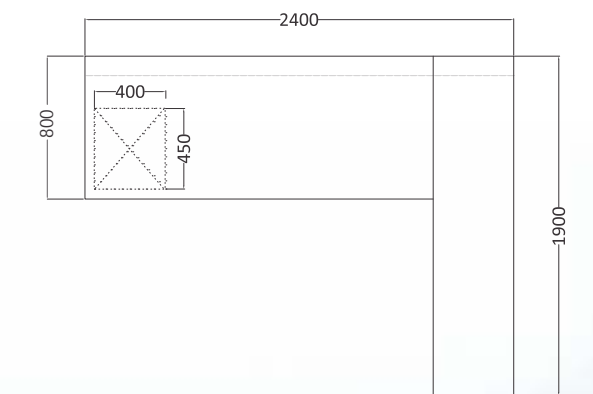

**DYNAMIC 3**  
W 2400 x D 800 x H 750





# DYNAMIC SERIES



**DYNAMIC 4**  
W 2100 x D 900 x H 750

### Product Features

- Aesthetic look, able to stand in line with many stylistic contexts.
- Its serves a dual containment function: externally with open shelves, inside with drawers and space for the files.

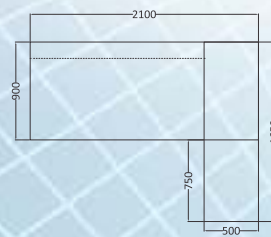

# PERFORM DESK SERIES

Featuring in futuristic design with optimal space, contrasting color with metal perforation combinations and ergonomic work surfaces to meet the demand of the dynamic officials, where form, material and function determine the characteristics of the workplaces.



**PERFORM 1**  
W 2100 x D 1950 x H 750

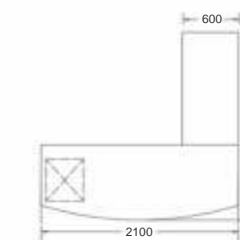

**PERFORM 4**  
W 1800 x D 800 x H 750



**PERFORM 5**  
W 1800 x D 860 x H 750



**PERFORM 6**  
W 2200 x D 1000 x H 750



**PERFORM 2**  
W 2400 x D 860 x H 750



**PERFORM 3**  
W 1600 x D 860 x H 750

**FUSION**  
SERIES

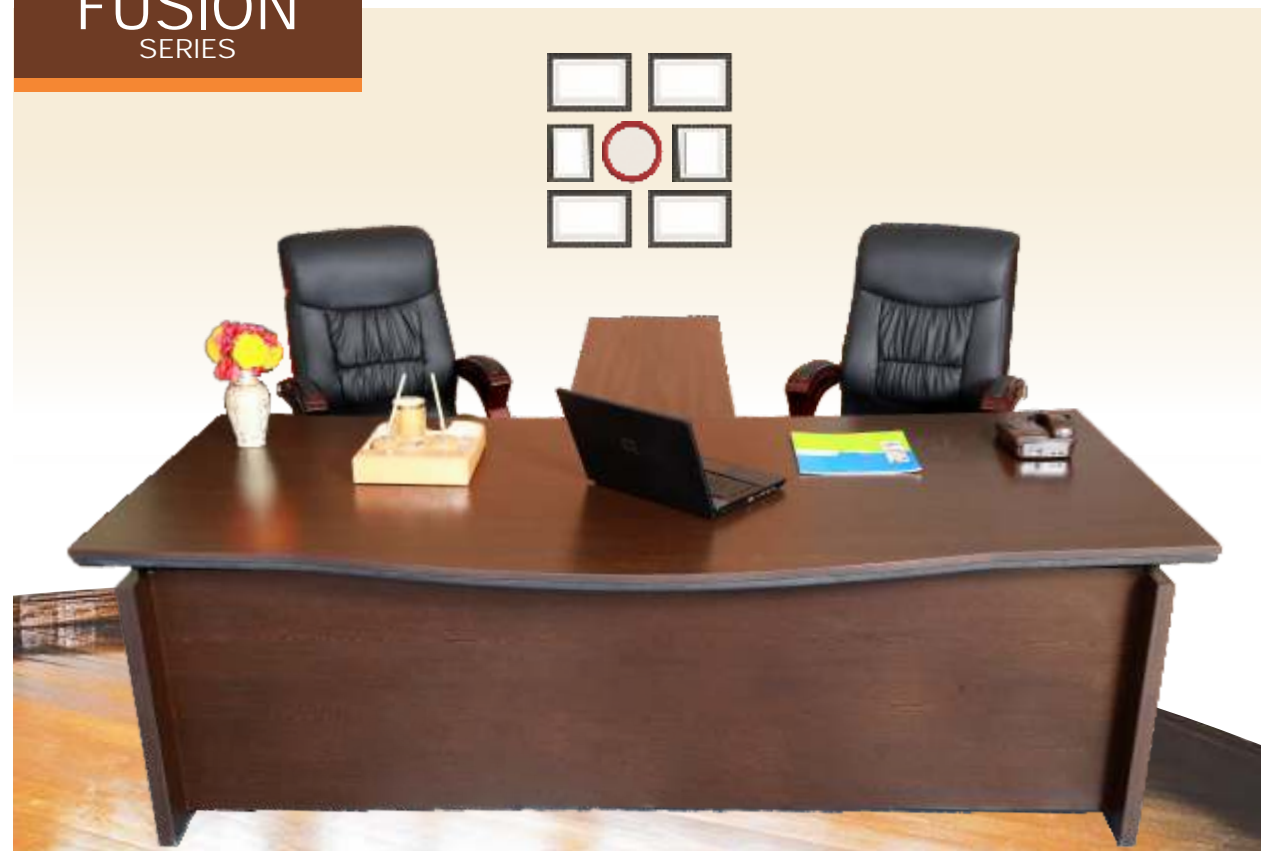

**FUSION 1**  
W 2400 x D 750 x H 750

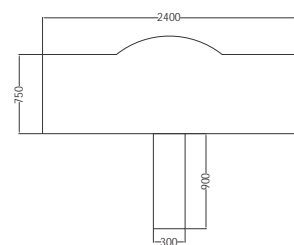

**Product Features**

- With perfect style, fashionable and tasted design.
- The Fusion tables that give space a consistent overall look.

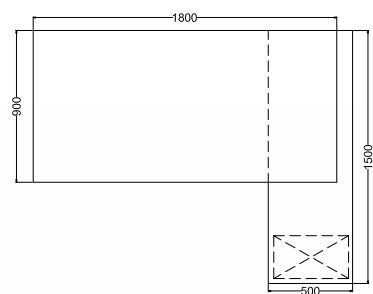

**FUSION 2**  
W 1800 x D 900 x H 750

**FUSION**  
SERIES



**FUSION 3**  
W 1950 x D 800 x H 750

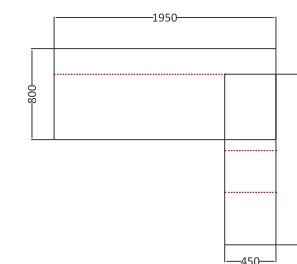

**FUSION 4**  
W 1500 x D 800 X H 750

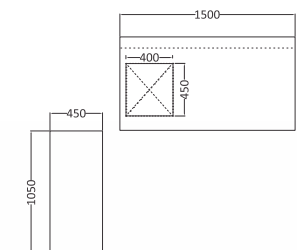

**FUSION**  
SERIES



**FUSION 5**  
W 1600 x D 750 x H 750

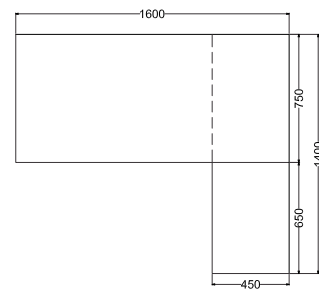

**FUSION**  
SERIES



**FUSION 7**  
W 2000 x D 750 x H 750

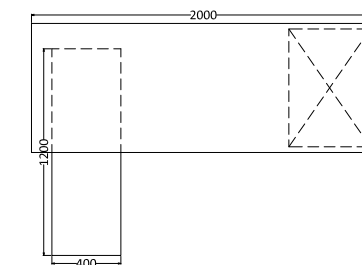

(METAL SUPPORT)



**FUSION 6**  
W 2000 x D 900 x H 750

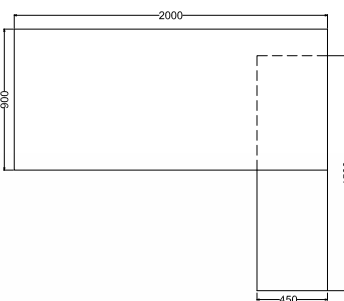

**FUSION 8**  
W 1800 x D 750 x H 750

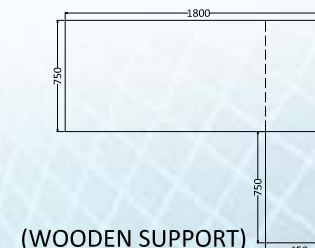

(WOODEN SUPPORT)

**ELEGANT**  
DESK SERIES

Elegant and simple designed to promote team working and easy communication in an open office environment. Its comes with low medium storages and fixed and mobile pedestals with key board tray and cpu trolley.

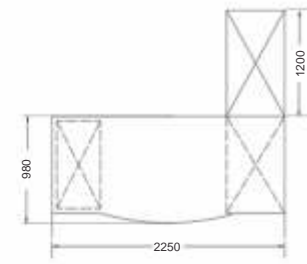

**ELEGANT 1**  
W 2250 x D 2180 x H 750



**ELEGANT**  
DESK SERIES



**ELEGANT 6**  
W 1800 x D 1850 x H 750

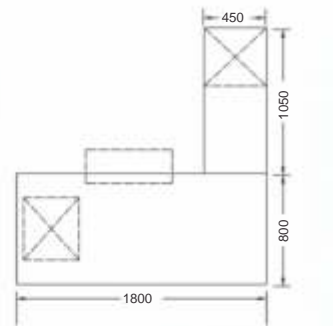

**ELEGANT 7**  
W 1800 x D 1730 x H 750

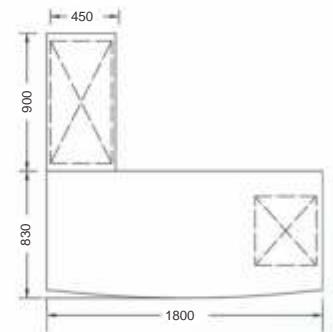

**ELEGANT 2**  
W 2000 x D 1200 x H 750

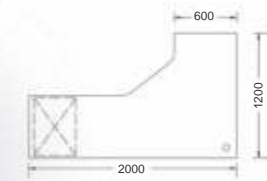

**ELEGANT 3**  
W 1800 x D 900 x H 750



**ELEGANT 4**  
W 1400 x D 700 x H 750



**ELEGANT 5**  
W 1600 x D 800 x H 750



**ELEGANT 8**  
W 2400 x D 1700 x H 750

**REVOLVE**  
DESK SERIES



Simple streamlined design of rectangular and with extended revolve top, tables matched with large capacity low long cabinets, back units, pedestal, key board tray and cpu trolley to meet the demand of senior officials.



**REVOLVE 1**  
W 2750 x D 2050 x H 750

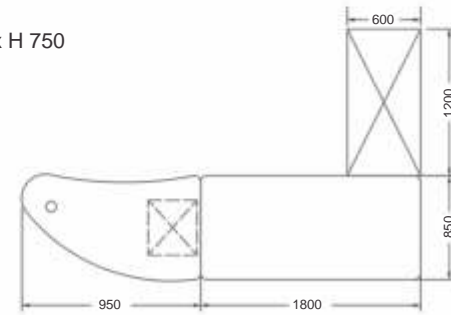

**REVOLVE**  
DESK SERIES



**REVOLVE 4**  
W 2850 x D 2100 x H 750

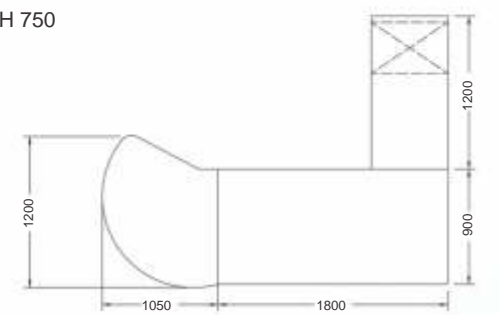

**REVOLVE 2**  
W 2400 x D 2400 x H 750

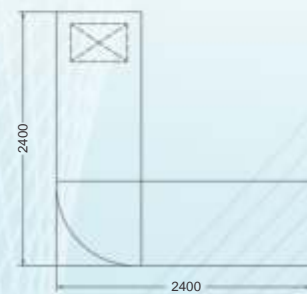

**REVOLVE 3**  
W 3600 x D 1200 x H 750



**REVOLVE 5**  
W 2400 x D 1900 x H 750

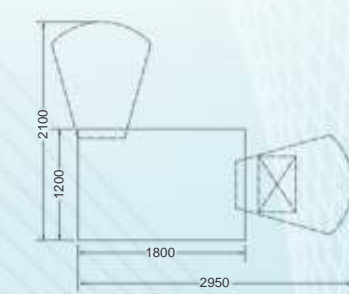
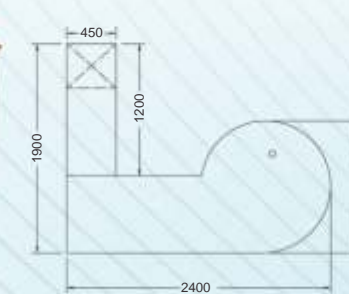

**REVOLVE 6**  
W 2950 x D 2100 x H 750

# CONFERENCE



**CONFERENCE 1**  
W 3600 x D 1200 x H 750

Good communication and healthy debate are essential to the success of any company. From individual tables to multi-unit layouts, in traditional or contemporary styles, Geeken Design offers a choice of versatile, practical, easy-to-manage meeting office furniture. It's an ideal conference desk series specially designed to have large & small corporate meetings /conferences and can be customized to client requirements as per the space available.



**CONFERENCE 2**  
W 4500 x D 1200 x H 750



**CONFERENCE 3**  
W 4000 x D 1600 x H 750

# CONFERENCE



**CONFERENCE 4**  
W 1760 x D 1760 x H 750



**CONFERENCE 5**  
W 2100 x D 1200 x H 750



**CONFERENCE 6**  
W 6000 x D 3000 x H 750



**CONFERENCE 7**  
φ 1200 x H 750

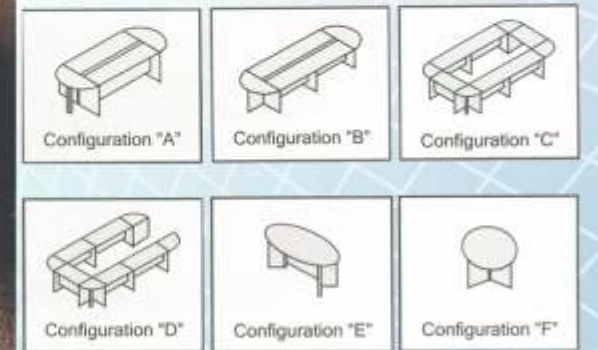

## CONFERENCE

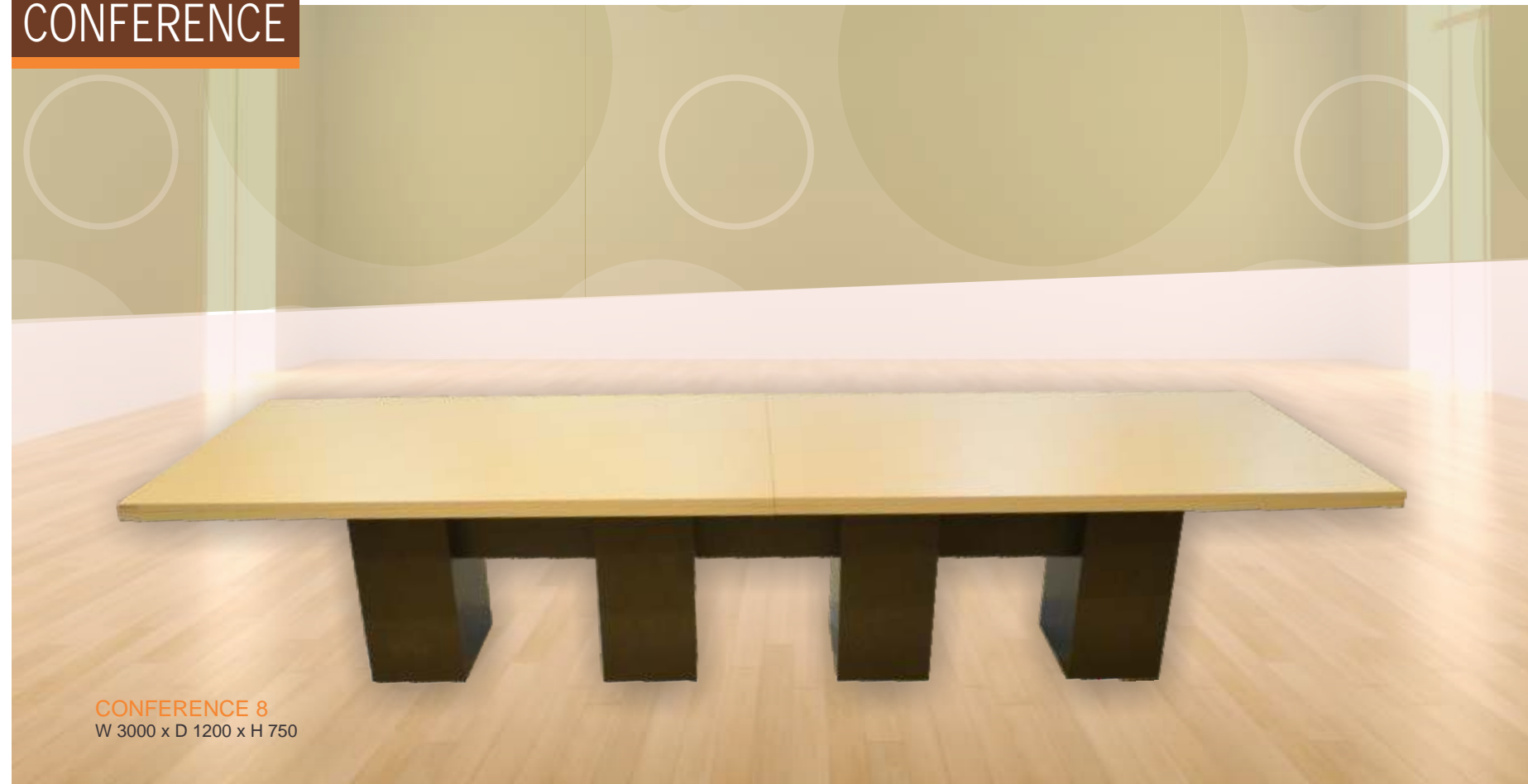

## NEW WORKSTATION



## INFRA FULL HEIGHT



An Infra series of full height panels for higher management offices, conference rooms and meeting rooms. Glass partitions are sophisticated and aesthetically designed; fulfilling the need for privacy, yet do not compromise at feeling of space and visual continuity.



## RECEPTION DESK

We never underestimate the magic of first impression. That's why we painstakingly design Reception Areas that win hearts and give an ambience of warmth and graciousness that make guest, clients and customers feel comfortable and welcomed.



RECEPTION 2  
W 1200 x D 750 x H 1000



RECEPTION 1  
W 2400 x D 700 x H 1000

## COMPUTER DESK

These computer desks have everything in it for comfortable working having two fixed drawers and one filling pedestal, a key board tray and space below the table top for CPU and filling.



COMPUTER DESK 1  
W 1500 x D 750 x H 750



COMPUTER DESK 2  
W 1200 x D 600 x H 750

## RECEPTION DESK



RECEPTION 3  
W 2400 x D 600 x H 1000

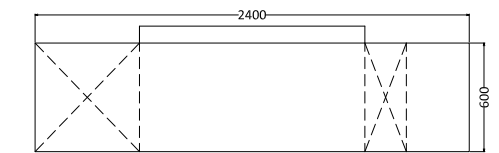

## COMPUTER DESK



COMPUTER DESK 3  
W 1200 x D 600 x H 750



Sometime individual choices breaks the matter of cost, here we offer premium series of storages for senior officials. Geeken Design has a wide choice of versatile, attractive design, customizable filing and storage units for every senior official.



**STORAGE 1**  
W 1800 x D 400 x H 2000



**STORAGE 2**  
W 1200 x D 400 x H 1850



**STORAGE 3**  
W 2300 x D 670 x H 1830



**STORAGE 4**  
W 1600 x D 400 x H 800



**STORAGE 5**  
W 1200 x D 450 x H 605



**STORAGE 6**  
W 1200 x D 500 x H 700



**STORAGE 7**  
W 1400 x D 450 x H 750

For managing of gadgets and files for daily easy access you need of space saving well designed storage solution that fit the modern workplace. Here we offer aesthetically designed project series storages for same look and theme of the whole office, fast installation, project effective cost and easy daily access.

**Product Features:**

- Available in Low Height, Medium Height, Full Height and Wall Hanging.
- Overhead storages for standing height access.
- Available with swing door and sliding door.
- Maximize Valuable storage space with standard size our units.
- Available in edge banded & post form laminated.
- Adjustable/fixed shelves.
- Complete fitting on Mini-Fix.
- Branded Hardware fittings.
- Easy to re-installation, dismantling and transporting



**STORAGE 8**  
W 900 x D 450 x H 750



**STORAGE 9**  
W 900 x D 450 x H 750



**STORAGE 10**  
W 900 x D 450 x H 1200



**STORAGE 12**  
W 900 x D 400 x H 900



**STORAGE 11**  
W 900 x D 450 x H 2100

**Configuration**

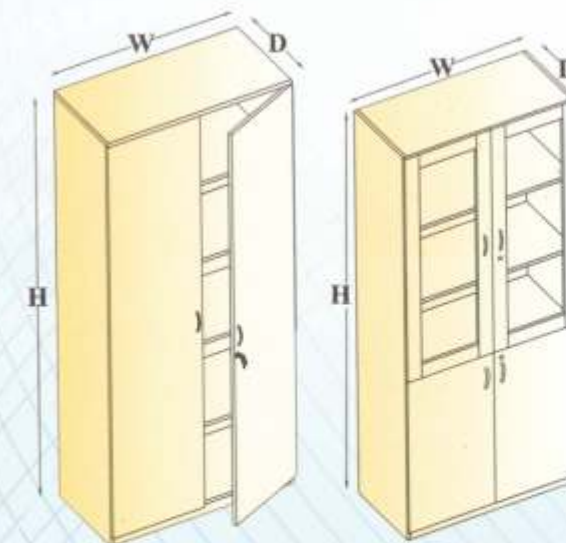

High Swing Door  
W=600,750,900  
D=400,450,500,550,600  
H=1650,1800,2100

High Swing Door with  
Glass & Wooden Shutters  
W=600,750,900  
D=400,450,500,550,600  
H=1650,1800,2100

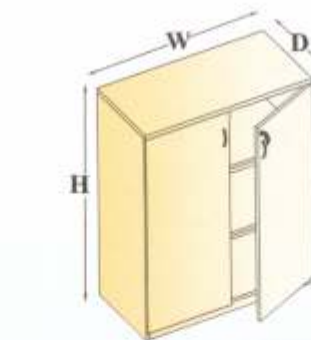

Medium Swing Door (2S)  
W=600,750,900  
D=400,450,500,550,600  
H=1175,1200,1350,1500

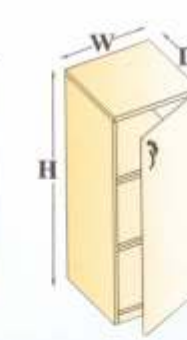

Medium Swing Door (1S)  
W=450,500,600  
D=300,350,380,400,450  
H=1175,1200,1350,1500

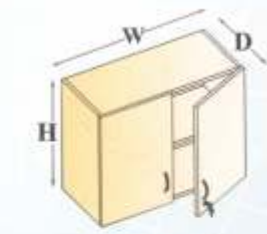

Over Head Storage  
W=600,750,900,1050,1200  
D=300,350,380,400,450  
H=450,600,750,800,900

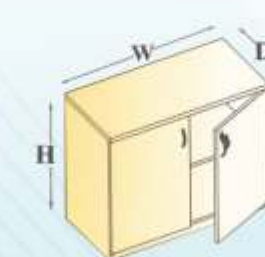

Low Swing Door  
W=600,750,900,1050,1200  
D=400,450,500,550,600  
H=750,800,900

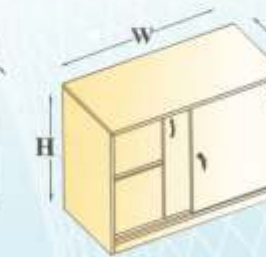

Low Sliding Door  
W=600,750,900,1050,1200  
D=400,450,500,550,600  
H=750,900,1200

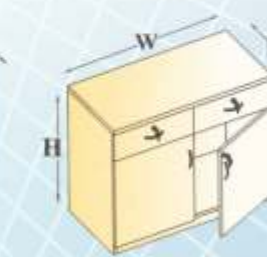

Side Cabinet  
W=600,750,900  
D=400,450  
H=750,900

# ACCESSORIES

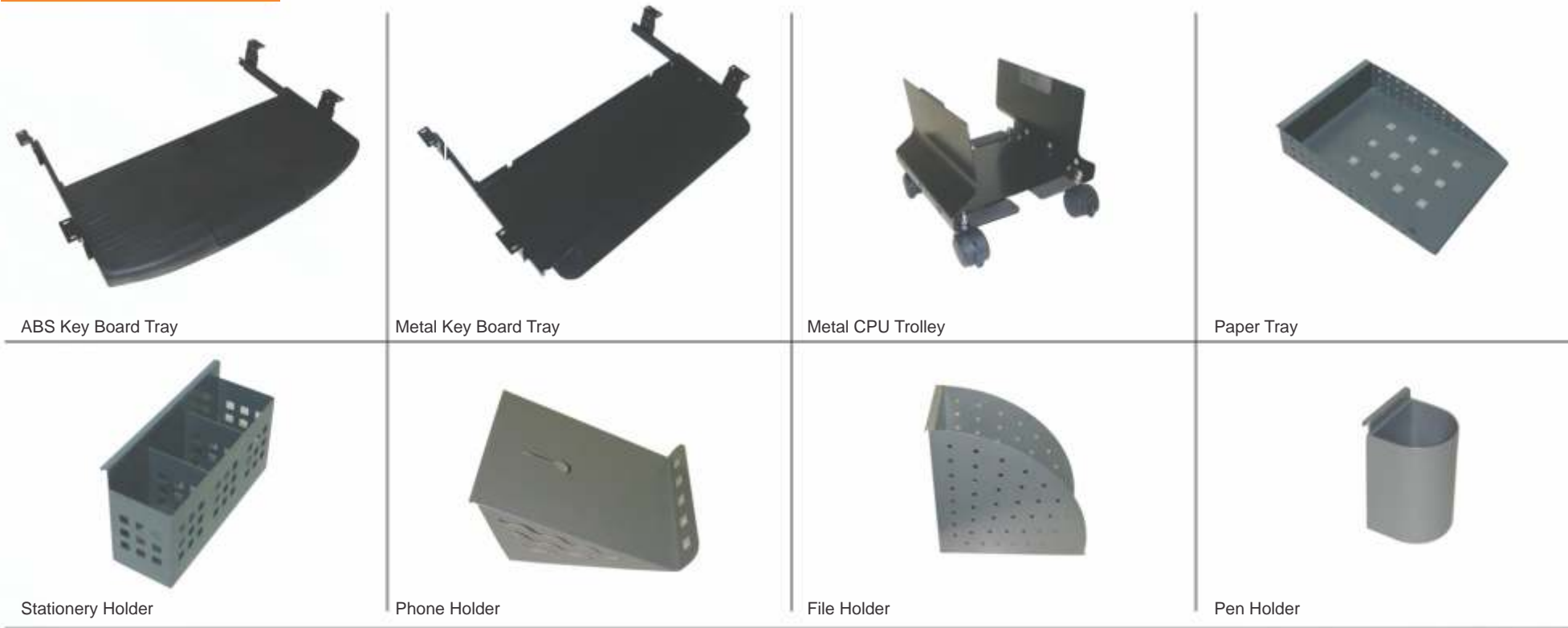

# PRODUCTION FACILITIES

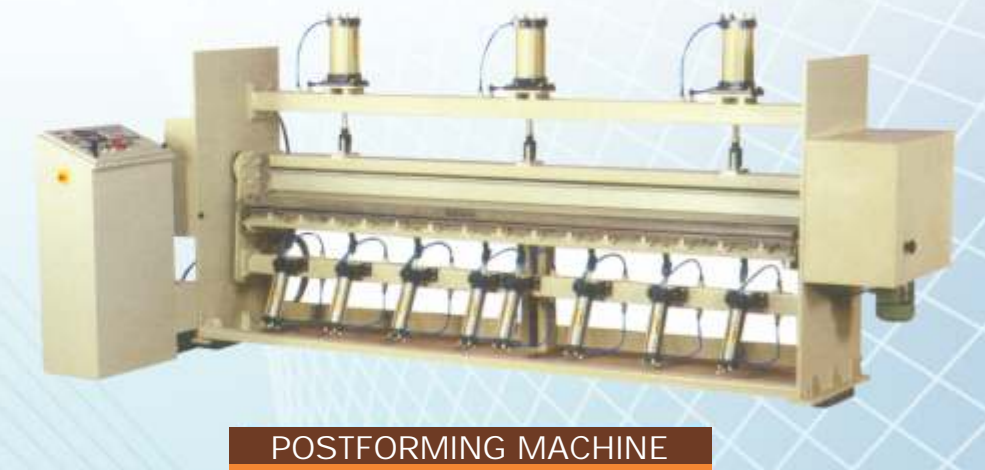

# PROJECTS



# PEDESTAL

Pedestal place below the work top for storing and keeping files, papers, pen, calculator etc. for daily easy and fast access. We are offering wide range of pedestals – fixed pedestals with work top, free standing pedestals and mobile pedestal on castors.

### Product Features:

- Available with utility drawers and filling drawers.
- Wide range of design according to use- fixed, mobile and free standing.
- Valuable storage for daily easy and fast access.
- Available with edge banded & post form laminated top.
- Multi Locking systems for locking with one key to all drawers.
- Complete fitting on Mini-Fix.
- Branded Hardware fittings.



**PEDESTAL 1** W 400 x D 560 x H 540      **PEDESTAL 2** W 440 x D 580 x H 600      **PEDESTAL 3** W 400 x D 450 x H 680      **PEDESTAL 4** W 400 x D 450 x H 680      **PEDESTAL 5** W 400 x D 600 x H 605      **PEDESTAL 6** W 400 x D 450 x H 670



**FIXED PEDESTAL (4D)**  
W=400,450  
D=450,500,550,600  
H=725



**Fixed Pedestal (2D/1F)**  
W=400,450  
D=450,500,550,600  
H=725



**Fixed Pedestal (2F)**  
W=400,450  
D=450,500,550,600  
H=725



**Fixed Pedestal (1D/1S)**  
W=400,450  
D=400,450,500,550,600  
H=725



**Free Standing Pedestal (4D)**  
W=400,450  
D=450,500,550,600  
H=700,725,750

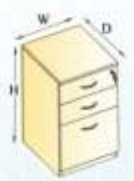

**Free Standing Pedestal (2D/1F)**  
W=400,450  
D=450,500,550,600  
H=700,725,750



**Free Standing Pedestal (2F)**  
W=400,450  
D=450,500,550,600  
H=725,750

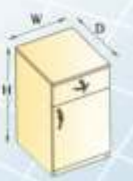

**Free Standing Pedestal (1D/1S)**  
W=400,450  
D=400,450,500,550,600  
H=700,725,750



**Mobile Pedestal (3D)**  
W=400,450  
D=450,500,550  
H=600



**Mobile Pedestal (2D/1F)**  
W=400,450  
D=450,500,550  
H=680,700



**Mobile Pedestal (2D/1F)**  
W=400,450  
D=450,500,550  
H=600



**Mobile Pedestal (1D/1S)**  
W=400,450  
D=450,500,550  
H=600,700



**Hanging Pedestal (2D)**  
W=300,400,450  
D=450,500  
H=300,350



**Single Hanging Drawer**  
W=300,400,450  
D=400,450,500  
H=125,150,200

# DESIGN OPTIONS

## WORK TOP OPTIONS

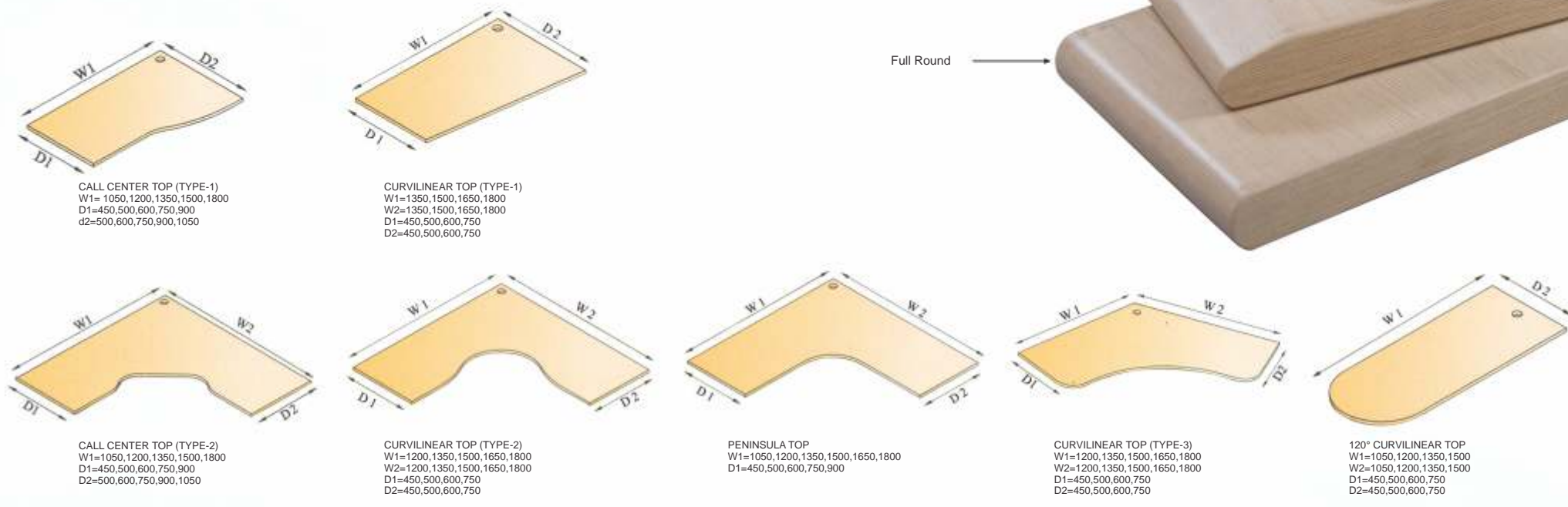

## CLUSTER OPTIONS

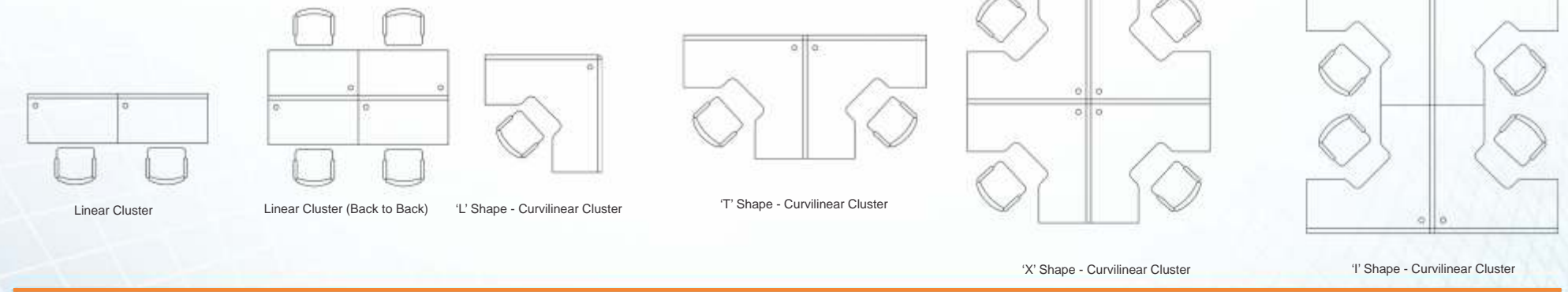

## GABLE OPTIONS

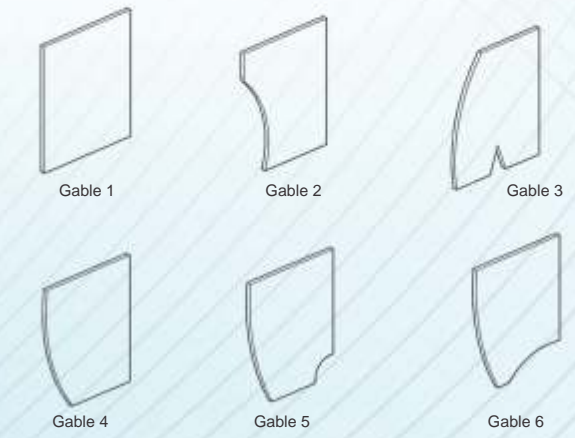

- Design & Specifications are subject to change without prior notice.
- All sizes mentioned are in MM
- Accessories & props (chair etc.) Shown in the pictures are not part of product.

## POSTFORMING PROFILE



## CLIENTS

Meet some of our esteemed clients



All logos shown above are sole property of their respective companies